

20STH Series 20mm 1.8° High Torque Hybrid Stepping Motor

Technical Specifications:

Model No.	Rated Voltage	Current /Phase	Resistance /Phase	Inductance /Phase	Holding Torque	# of Leads	Rotor Inertia	Weight	Length
Single Shaft	V	A	Ω	mH	g-cm	ii	kg-m ²	kg	mm
20STH30-0604A	3.9	0.6	6.5	1.7	180	4	2.0×10^{-7}	0.06	30
20STH33-0604A	3.9	0.6	6.5	1.7	180	4	2.0×10^{-7}	0.06	33
20STH42-0804A	4.32	0.8	5.4	1.5	300	4	3.6×10^{-7}	0.08	42

General Specifications:

Item	Specifications
Step Angle	1.8°
Step Angle Accuracy	±5% (full step, no load)
Resistance Accuracy	±10%
Inductance Accuracy	±20%
Temperature Rise	80°C Max. (rated current, 2 phase on)
Ambient Temperature	-20°C~+50°C
Insulation Resistance	100M Ω Min., 500VDC
Dielectric Strength	500VAC for one minute
Shaft Radial Play	0.02Max. (450g load)
Shaft Axial Play	0.08Max. (450g load)
Rotation	CW (facing the front flange)



Dimensional Drawing (mm)

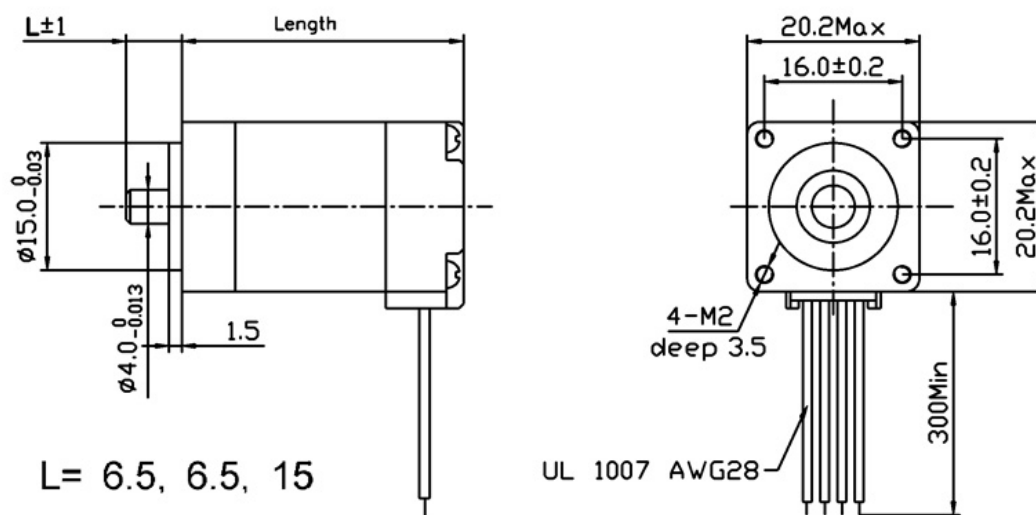

Wiring Diagram

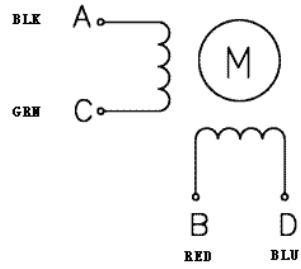

Pull out torque

